



# Northumberland County Council

Licensing Department, Business Compliance & Public Safety Unit, Public Protection Service, West Hartford Business Park, Cramlington, Northumberland, NE23 3JP  
Tel: 0345 6006400

## Application to vary a premises licence under the Licensing Act 2003

### PLEASE READ THE FOLLOWING INSTRUCTIONS FIRST

Before completing this form please read the guidance notes at the end of the form.  
If you are completing this form by hand please write legibly in block capitals. In all cases ensure that your answers are inside the boxes and written in black ink. Use additional sheets if necessary.

You may wish to keep a copy of the completed form for your records.

I/We [REDACTED] (Vice Leisure Ltd)

*(Insert name(s) of applicant)*

**being the premises licence holder, apply to vary a premises licence under section 34 of the Licensing Act 2003 for the premises described in Part 1 below**

**Premises licence number NPR / 1653**

#### Part 1 – Premises Details

**Postal address of premises or, if none, ordnance survey map reference or description**

Vice City Club & Bar  
5 North Seaton Road

<b>Post town</b>	Ashington	<b>Post code</b>	NE63 0AF
------------------	-----------	------------------	----------

Telephone number at premises (if any)	<span style="background-color: black; color: black;">[REDACTED]</span>
---------------------------------------	--

Non-domestic rateable value of premises	£ 13,150
---	----------

#### Part 2 – Applicant details

<b>Daytime contact telephone number</b>	<span style="background-color: black; color: black;">[REDACTED]</span>
<b>E-mail address (optional)</b>	<span style="background-color: black; color: black;">[REDACTED]</span>
<b>Current postal address if different from premises address</b>	<span style="background-color: black; color: black;">[REDACTED]</span>

<b>Post Town</b>					<b>Postcode</b>				
------------------	--	--	--	--	-----------------	--	--	--	--

**Part 3 - Variation**

Please tick yes

Do you want the proposed variation to have effect as soon as possible?

Y

If not do you want the variation to take effect from

Day Month Year

--	--	--	--	--	--	--	--	--	--

**Please describe briefly the nature of the proposed variation (Please see guidance note 1)**

Extension of operating hours  
Monday to Sunday 11:00 - 03:00  
Live Music 18:00 – 01:00  
DJ 12:00 – 02:30 (these early hours are purely for brunch and afternoon events)  
Supply of Alcohol 11:00 – 02:30  
Recorded Music 11:00 – 02:30

If your proposed variation would mean that 5,000 or more people are expected to attend the premises at any one time, please state the number expected to attend

N/A
-----

#### **Part 4 Operating Schedule**

Please complete those parts of the Operating Schedule below which would be subject to change if this application to vary is successful.

<b><u>Provision of regulated entertainment</u></b>	<b>Please tick yes</b>
a) plays (if ticking yes, fill in box A)	Y
b) films (if ticking yes, fill in box B)	Y
c) indoor sporting events (if ticking yes, fill in box C)	Y
d) boxing or wrestling entertainment (if ticking yes, fill in box D)	Y
e) live music (if ticking yes, fill in box E)	Y
f) recorded music (if ticking yes, fill in box F)	Y
g) performances of dance (if ticking yes, fill in box G)	Y
h) anything of a similar description to that falling within (e), (f) or (g) (if ticking yes, fill in box H)	Y
<b><u>Provision of entertainment facilities:</u></b>	
i) making music (if ticking yes, fill in box I)	Y
j) dancing (if ticking yes, fill in box J)	Y
k) entertainment of a similar description to that falling within (i) or (j) (if ticking yes, fill in box K)	Y
<b><u>Provision of late night refreshment</u></b> (if ticking yes, fill in box L)	Y
<b><u>Sale by retail of alcohol</u></b> (if ticking yes, fill in box M)	Y

**In all cases complete boxes N, O and P**

**A**

<b>Plays</b> Standard days and timings (please read guidance note 6)			<b><u>Will the performance of a play take place indoors or outdoors or both – please tick</u></b> (please read guidance note 2)	Indoors	Y
Day	Start	Finish		Outdoors	<input type="checkbox"/>
				Both	<input type="checkbox"/>
Mon	11:00	23:00	<b><u>Please give further details here</u></b> (please read guidance note 3)  Performers of local and national play and theatrical groups may use amplified system		
Tue	11:00	23:00			
Wed	11:00	23:00	<b><u>State any seasonal variations for performing plays</u></b> (please read guidance note 4)  N/A		
Thur	11:00	23:00			
Fri	11:00	23:00	<b><u>Non standard timings. Where you intend to use the premises for the performance of plays at different times to those listed in the column on the left, please list</u></b> (please read guidance note 5)  N/A		
Sat	11:00	23:00			
Sun	11:00	23:00			

**B**

<b>Films</b> Standard days and timings (please read guidance note 6)			<b>Will the exhibition of films take place indoors or outdoors or both – please tick</b> (please read guidance note 2)	Indoors	Y
				Outdoors	<input type="checkbox"/>
				Both	<input type="checkbox"/>
Day	Start	Finish	<b>Please give further details here</b> (please read guidance note 3)  We may get asked to show films and local productions		
Mon	11:00	23:00			
Tue	11:00	23:00	<b>State any seasonal variations for the exhibition of films</b> (please read guidance note 4)		
Wed	11:00	23:00			
Thur	11:00	23:00	NA		
Fri	11:00	23:00			
Sat	11:00	23:00	NA		
Sun	11:00	23:00			

**C**

<b>Indoor sporting events</b> Standard days and timings (please read guidance note 6)			<b><u>Please give further details</u></b> (please read guidance note 3)
Day	Start	Finish	
Mon	11:00	23:00	It is unlikely we will get asked to host indoor sporting events but we would like to be covered for snooker, table tennis and other events
Tue	11:00	23:00	<b><u>State any seasonal variations for indoor sporting events</u></b> (please read guidance note 4)
Wed	11:00	23:00	NA
Thur	11:00	23:00	<b><u>Non standard timings. Where you intend to use the premises for indoor sporting events at different times to those listed in the column on the left, please list</u></b> (please read guidance note 5)
Fri	11:00	23:00	NA
Sat	11:00	23:00	
Sun	11:00	23:00	

**D**

<b>Boxing or wrestling entertainments</b> Standard days and timings (please read guidance note 6)			<b>Will the boxing or wrestling entertainment take place indoors or outdoors or both – please tick</b> (please read guidance note 2)	Indoors	Y
Day	Start	Finish		Outdoors	<input type="checkbox"/>
Mon	11:00	23:00	<b>Please give further details here</b> (please read guidance note 3)  Unlikely to get these type of events due to the small size of the venue but we would like to be covered	Both	<input type="checkbox"/>
Tue	11:00	23:00			
Wed	11:00	23:00	<b>State any seasonal variations for boxing or wrestling entertainment</b> (please read guidance note 4)  NA		
Thur	11:00	23:00			
Fri	11:00	23:00	<b>Non standard timings. Where you intend to use the premises for boxing or wrestling entertainment at different times to those listed in the column on the left, please list</b> (please read guidance note 5)  NA		
Sat	11:00	23:00			
Sun	11:00	23:00			

**E**

<b>Live music</b> Standard days and timings (please read guidance note 6)			<b>Will the performance of live music take place indoors or outdoors or both – please tick</b> (please read guidance note 2)	Indoors	<input checked="" type="checkbox"/>
				Outdoors	<input type="checkbox"/>
				Both	<input type="checkbox"/>
<b>Day</b>	<b>Start</b>	<b>Finish</b>	<b>Please give further details here</b> (please read guidance note 3)		
Mon	18:00	01:00	Bands, groups, dup's with amplified and unamplified music		
Tue	18:00	01:00			
Wed	18:00	01:00	<b>State any seasonal variations for the performance of live music</b> (please read guidance note 4)		
Thur	18:00	01:00	NA		
Fri	18:00	01:00	<b>Non standard timings. Where you intend to use the premises for the performance of live music at different times to those listed in the column on the left, please list</b> (please read guidance note 5)		
Sat	18:00	01:00	NA		
Sun	18:00	01:00			



**F**

Recorded music Standard days and timings (please read guidance note 6)			Will the playing of recorded music take place indoors or outdoors or both – please tick (please read guidance note 2)	Indoors	Y
Day	Start	Finish		Outdoors	<input type="checkbox"/>
Mon	11:00	02:30	<b>Please give further details here</b> (please read guidance note 3)  Music will be played including Disco/DJ, amplified music using a PA system	Both	<input type="checkbox"/>
Tue	11:00	02:30			
Wed	11:00	02:30	<b>State any seasonal variations for the playing of recorded music</b> (please read guidance note 4)  NA		
Thur	11:00	02:30			
Fri	11:00	02:30	<b>Non standard timings. Where you intend to use the premises for the playing of recorded music at different times to those listed in the column on the left, please list</b> (please read guidance note 5)  NA		
Sat	11:00	02:30			
Sun	11:00	02:30			

**G**

<b>Performances of dance</b> Standard days and timings (please read guidance note 6)			<b><u>Will the performance of dance take place indoors or outdoors or both – please tick</u></b> (please read guidance note 2)	Indoors	Y
Day	Start	Finish		Outdoors	<input type="checkbox"/>
Mon	11:00	23:00	<b><u>Please give further details here</u></b> (please read guidance note 3)  Childrens and adults dance schools, competitions, line dancing etc	Both	<input type="checkbox"/>
Tue	11:00	23:00			
Wed	11:00	23:00	<b><u>State any seasonal variations for the performance of dance</u></b> (please read guidance note 4)  NA		
Thur	11:00	23:00			
Fri	11:00	23:00	<b><u>Non standard timings. Where you intend to use the premises for the performance of dance at different times to those listed in the column on the left, please list</u></b> (please read guidance note 5)  NA		
Sat	11:00	23:00			
Sun	11:00	23:00			

H

<b>Anything of a similar description to that falling within (e), (f) or (g)</b> Standard days and timings (please read guidance note 6)			<b><u>Please give a description of the type of entertainment you will be providing</u></b>  Live singers, bands and disco/DJ		
<b>Day</b>	<b>Start</b>	<b>Finish</b>	<b><u>Will this entertainment take place indoors or outdoors or both – please tick</u></b> (please read guidance note 2)	Indoors	Y
Mon	11:00	23:00		Outdoors	<input type="checkbox"/>
				Both	<input type="checkbox"/>
Tue	11:00	23:00	<b><u>Please give further details here</u></b> (please read guidance note 3)  NA		
Wed	11:00	23:00			
Thur	11:00	23:00	<b><u>State any seasonal variations for entertainment of a similar description to that falling within (e), (f) or (g)</u></b> (please read guidance note 4)		
Fri	11:00	23:00	NA		
Sat	11:00	23:00	<b><u>Non standard timings. Where you intend to use the premises for the entertainment of a similar description to that falling within (e), (f) or (g) at different times to those listed in the column on the left, please list</u></b> (please read guidance note 5)		
Sun	11:00	23:00	NA		

<b>Provision of facilities for making music</b> Standard days and timings (please read guidance note 6)			<b><u>Please give a description of the facilities for making music you will be providing</u></b>  This will vary from event to event but anything that falls within the category of 'making music facilities' will be considered	
			<b><u>Will the facilities for making music be indoors or outdoors or both – please tick</u></b> (please read guidance note 2)	
Day	Start	Finish	<b><u>Please give further details here</u></b> (please read guidance note 3)  NA	
Mon	11:00	23:00		
Tue	11:00	23:00		
Wed	11:00	23:00		
Thur	11:00	23:00		
Fri	11:00	23:00		
Sat	11:00	23:00		
Sun	11:00	23:00	<b><u>State any seasonal variations for the provision of facilities for making music</u></b> (please read guidance note 4)  NA	
			<b><u>Non standard timings. Where you intend to use the premises for provision of facilities for making music at different times to those listed in the column on the left, please list</u></b> (please read guidance note 5)  NA	

**J**

<b>Provision of facilities for dancing</b> Standard days and timings (please read guidance note 6)			<b>Will the facilities for dancing be indoors or outdoors or both – please tick</b> (see guidance note 2)	Indoors	Y
				Outdoors	<input type="checkbox"/>
				Both	<input type="checkbox"/>
Day	Start	Finish	<b>Please give a description of the facilities for dancing you will be providing</b>  This will vary from event but anything that falls within the category of 'facilities for dancing' will be considered		
Mon	11:00	23:00	<b>Please give further details here</b> (please read guidance note 3)  NA		
Tue	11:00	23:00			
Wed	11:00	23:00	<b>State any seasonal variations for providing dancing facilities</b> (please read guidance note 4)  NA		
Thur	11:00	23:00			
Fri	11:00	23:00	<b>Non standard timings. Where you intend to use the premises for the provision of facilities for dancing at different times to those listed in the column on the left, please list</b> (please read guidance note 5)  NA		
Sat	11:00	23:00			
Sun	11:00	23:00			

**K**

<b>Provision of facilities for entertainment of a similar description to that falling within i or j</b> Standard days and timings (please read guidance note 6)			<b><u>Please give a description of the type of entertainment facility you will be providing</u></b>  This will vary from event but anything that falls within the category of 'facilities for entertainment' will be considered		
Day	Start	Finish	<b><u>Will the entertainment facility be indoors or outdoors or both – please tick</u></b> (please read guidance note 2)	Indoors	Y
Mon	11:00	23:00		Outdoors	<input type="checkbox"/>
				Both	<input type="checkbox"/>
Tue	11:00	23:00	<b><u>Please give further details here</u></b> (please read guidance note 3)		
			NA		
Wed	11:00	23:00			
Thur	11:00	23:00	<b><u>State any seasonal variations for the provision of facilities for entertainment of a similar description to that falling within i or j</u></b> (please read guidance note 4)		
			NA		
Fri	11:00	23:00			
Sat	11:00	23:00	<b><u>Non standard timings. Where you intend to use the premises for the provision of facilities for entertainment of a similar description to that falling within i or j at different times to those listed in the column on the left, please list</u></b> (please read guidance note 5)		
Sun	11:00	23:00	NA		

**L**

<b>Late night refreshment</b> Standard days and timings (please read guidance note 6)			<b>Will the provision of late night refreshment take place indoors or outdoors or both – please tick</b> (please read guidance note 2)	Indoors	Y
Day	Start	Finish		Outdoors	<input type="checkbox"/>
Mon	23:00	02:30	<p><b>Please give further details here</b> (please read guidance note 3)</p> <p>Pay bar will be open when venue operates – we only aim to use the the 02:30 hours on a Friday and Saturday and bank holiday Sundays</p> <p>We want to be covered for all nights of the week just incase we try and put on a student night, themed night etc</p>	Both	<input type="checkbox"/>
Tue	23:00	02:30			
Wed	23:00	02:30		<b>State any seasonal variations for the provision of late night refreshment</b> (please read guidance note 4)	
Thur	23:00	02:30		NA	
Fri	23:00	02:30		<b>Non standard timings. Where you intend to use the premises for the provision of late night refreshment at different times, to those listed in the column on the left, please list</b> (please read guidance note 5)	
Sat	23:00	02:30		NA	
Sun	23:00	02:30			

**M**

<b>Supply of alcohol</b> Standard days and timings (please read guidance note 6)			<b>Will the supply of alcohol be for consumption (Please tick box)</b> (please read guidance note 7)	On the premises	<input checked="" type="checkbox"/>
				Off the premises	<input type="checkbox"/>
				Both	<input type="checkbox"/>
<b>Day</b>	<b>Start</b>	<b>Finish</b>	<b>State any seasonal variations for the supply of alcohol</b> (please read guidance note 4)  NA   <b>Non-standard timings. Where you intend to use the premises for the supply of alcohol at different times to those listed in the column on the left, please list</b> (please read guidance note 5)  NA		
Mon	11:00	02:30			
Tue	11:00	02:30			
Wed	11:00	02:30			
Thur	11:00	02:30			
Fri	11:00	02:30			
Sat	11:00	02:30			
Sun	11:00	02:30			

**N**

**Please highlight any adult entertainment or services, activities, other entertainment or matters ancillary to the use of the premises that may give rise to concern in respect of children** (please read guidance note 8)

NA



O

<b>Hours premises are open to the public</b> Standard days and timings (please read guidance note 6)			<b>State any seasonal variations</b> (please read guidance note 4)  NA
Day	Start	Finish	
Mon	11:00	03:00	
Tue	11:00	03:00	
Wed	11:00	03:00	
Thur	11:00	03:00	
Fri	11:00	03:00	
Sat	11:00	03:00	<b>Non standard timings. Where you intend the premises to be open to the public at different times from those listed in the column on the left, please list</b> (please read guidance note 5)  NA
Sun	11:00	03:00	

Please identify those conditions currently imposed on the licence which you believe could be removed as a consequence of the proposed variation you are seeking

16: Be a minimum of 1 SIA door supervisor employed on a Friday night with a radio link to other bars should we need help. Saturday we will have a minimum of 2 SIA door supervisors from 21:00

17: Take this out completely

18: Change to 21:00

19: Change to 21:00

24: Last entry 01:00

26: Take out or change to No Dress Code

Please tick yes

- I have enclosed the premises licence Y
- I have enclosed the relevant part of the premises licence Y

If you have not ticked one of these boxes please fill in reasons for not including the licence, or part of it, below

Reasons why I have failed to enclose the premises licence or relevant part of premises licence

**P** Describe any additional steps you intend to take to promote the four licensing objectives as a result of the proposed variation:

**a) General – all four licensing objectives (b,c,d,e) (please read guidance note 9)**

We have been operating the venue since April 2023 and are responsible operators. All staff have been trained on their licensing responsibilities, including the prevention of underage sales, challenge 25 policy and CCTV installed, SIA registered door staff used every weekend.

**b) The prevention of crime and disorder**

Please see above

**c) Public safety**

Please see above

**d) The prevention of public nuisance**

Please see above

**e) The protection of children from harm**

Please see above

- Please tick yes**
- I have made or enclosed payment of the fee Y
  - I have sent copies of this application and the plan to responsible authorities and others where applicable Y
  - I understand that I must now advertise my application Y
  - I have enclosed the premises licence or relevant part of it or explanation Y
  - I understand that if I do not comply with the above requirements my application will be rejected Y

**IT IS AN OFFENCE, LIABLE ON CONVICTION TO A FINE UP TO LEVEL 5 ON THE STANDARD SCALE, UNDER SECTION 158 OF THE LICENSING ACT 2003 TO MAKE A FALSE STATEMENT IN OR IN CONNECTION WITH THIS APPLICATION**

**Part 5 – Signatures** (please read guidance note 10)

**Signature of applicant (the current premises licence holder) or applicant's solicitor or other duly authorised agent** (please read guidance note 11). **If signing on behalf of the applicant please state in what capacity.**

Signature	
Date	04-01-2024
Capacity	Director

**Where the premises licence is jointly held signature of 2nd applicant (the current premises licence holder) or 2nd applicant's solicitor or other authorised agent** (please read guidance note 12). **If signing on behalf of the applicant please state in what capacity.**

Signature	
Date	
Capacity	

<b>Contact name (where not previously given) and address for correspondence associated with this application (please read guidance note 13)</b>			
<b>Post town</b>		<b>Post code</b>	
<b>Telephone number (if any)</b>			
<b>If you would prefer us to correspond with you by e-mail your e-mail address (optional)</b>			

When complete, return this form to the nearest Northumberland County Council licensing office – please refer to the guidance notes on the website for details.

## Notes for Guidance

**This application cannot be used to vary the licence so as to extend the period for which the licence has effect or to vary substantially the premises to which it relates. If you wish to make that type of change to the premises licence you should make a new premises licence application under section 17 of the Licensing Act 2003.**

1. Describe the premises. For example the type of premises, its general situation and layout and any other information which could be relevant to the licensing objectives. Where your application includes off-supplies of alcohol and you intend to provide a place for consumption of these off-supplies you must include a description of where the place will be and its proximity to the premises.
2. Where taking place in a building or other structure please tick as appropriate. Indoors may include a tent.
3. For example state type of activity to be authorised, if not already stated, and give relevant further details, for example (but not exclusively) whether or not music will be amplified or unamplified.
4. For example (but not exclusively), where the activity will occur on additional days during the summer months.
5. For example (but not exclusively), where you wish the activity to go on longer on a particular day e.g. Christmas Eve.
6. Please give timings in 24 hour clock (e.g. 16:00) and only give details for the days of the week when you intend the premises to be used for the activity.
7. If you wish people to be able to consume alcohol on the premises please tick on, if you wish people to be able to purchase alcohol to consume away from the premises please tick off. If you wish people to be able to do both please tick both.
8. Please give information about anything intended to occur at the premises or ancillary to the use of the premises which may give rise to concern in respect of children regardless of whether you intend children to have access to the premises, for example (but not exclusively) nudity or semi-nudity, films for restricted age groups, the presence of gaming machines.
9. Please list here steps you will take to promote all four licensing objectives together.
10. The application form must be signed.
11. An applicant's agent (for example solicitor) may sign the form on their behalf provided that they have actual authority to do so.
12. Where there is more than one applicant, both applicants or their respective agents must sign the application form.
13. This is the address which we shall use to correspond with you about this application.

Checklist:

Please tick to indicate agreement

- I have made or enclosed payment of the fee; or
- I have not made or enclosed payment of the fee because this application has been made in relation to the introduction of the late night levy.
- I have sent copies of this application and the plan to responsible authorities and others where applicable.
- I understand that I must now advertise my application.
- I have enclosed the premises licence or relevant part of it or explanation.
- I understand that if I do not comply with the above requirements my application will be rejected.

**IT IS AN OFFENCE, UNDER SECTION 158 OF THE LICENSING ACT 2003, TO MAKE A FALSE STATEMENT IN OR IN CONNECTION WITH THIS APPLICATION. THOSE WHO MAKE A FALSE STATEMENT MAY BE LIABLE ON SUMMARY CONVICTION TO A FINE OF ANY AMOUNT.**

**Part 5 – Signatures (please read guidance note 12)**

**Signature of applicant (the current premises licence holder) or applicant’s solicitor or other duly authorised agent (please read guidance note 13). If signing on behalf of the applicant, please state in what capacity.**

Signature	[REDACTED]
Date	04-01-24
Capacity	DIRECTOR.

**Where the premises licence is jointly held, signature of 2nd applicant (the current premises licence holder) or 2nd applicant’s solicitor or other authorised agent (please read guidance note 14). If signing on behalf of the applicant, please state in what capacity.**

Signature	
Date	
Capacity	

**Contact name (where not previously given) and address for correspondence associated with this application (please read guidance note 15)**

Post town	Post code





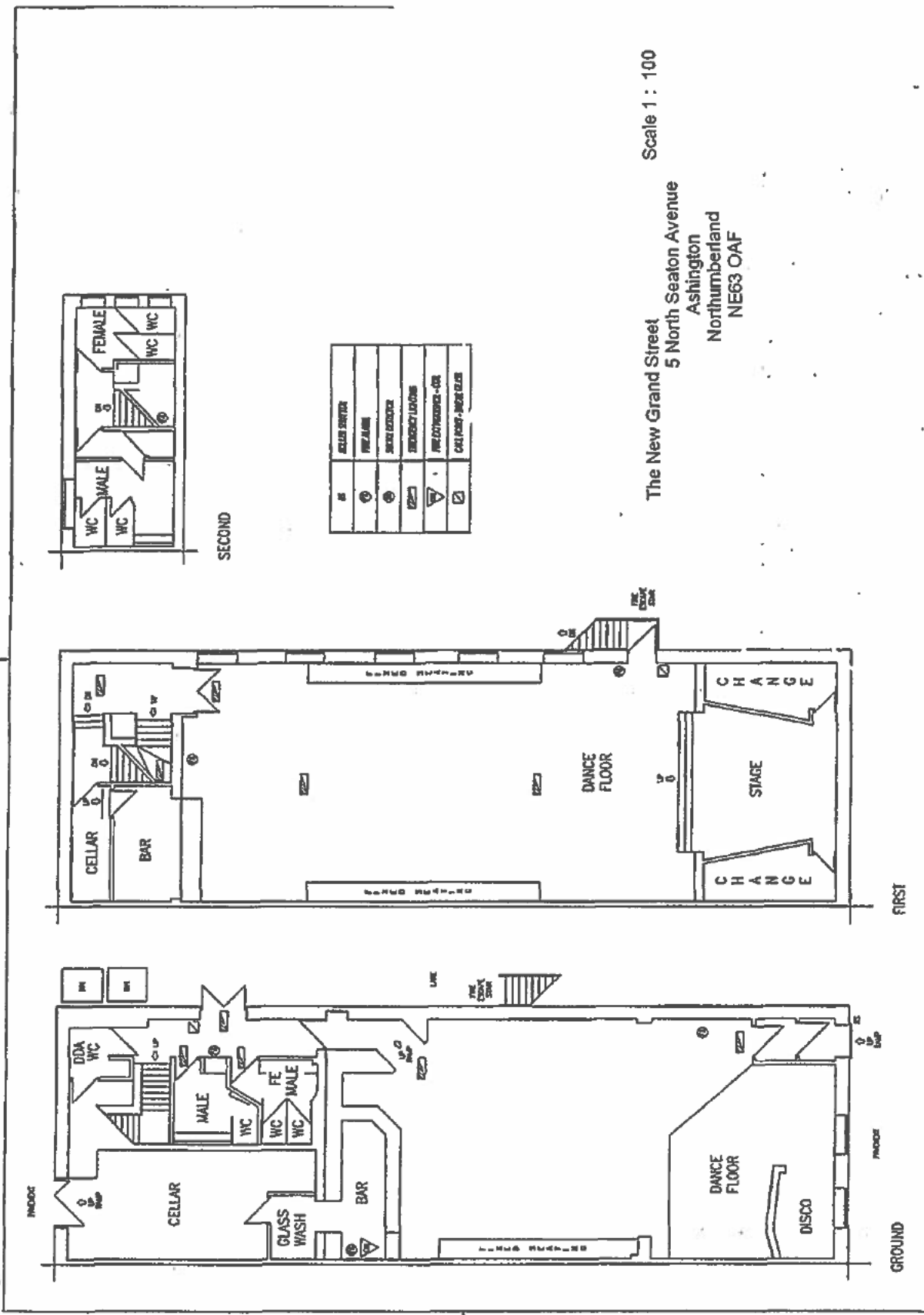

Scale 1 : 100

The New Grand Street  
 5 North Seaton Avenue  
 Ashington  
 Northumberland  
 NE63 0AF

AS	CLUB SERVER
①	W.C. MALE
②	W.C. FEMALE
③	STAIRS
④	STAIRS
⑤	STAIRS
⑥	STAIRS
⑦	STAIRS
⑧	STAIRS
⑨	STAIRS
⑩	STAIRS
⑪	STAIRS
⑫	STAIRS
⑬	STAIRS
⑭	STAIRS
⑮	STAIRS
⑯	STAIRS
⑰	STAIRS
⑱	STAIRS
⑲	STAIRS
⑳	STAIRS
㉑	STAIRS
㉒	STAIRS
㉓	STAIRS
㉔	STAIRS
㉕	STAIRS
㉖	STAIRS
㉗	STAIRS
㉘	STAIRS
㉙	STAIRS
㉚	STAIRS
㉛	STAIRS
㉜	STAIRS
㉝	STAIRS
㉞	STAIRS
㉟	STAIRS
㊱	STAIRS
㊲	STAIRS
㊳	STAIRS
㊴	STAIRS
㊵	STAIRS
㊶	STAIRS
㊷	STAIRS
㊸	STAIRS
㊹	STAIRS
㊺	STAIRS
㊻	STAIRS
㊼	STAIRS
㊽	STAIRS
㊾	STAIRS
㊿	STAIRS

SECOND

FIRST

GROUND

